

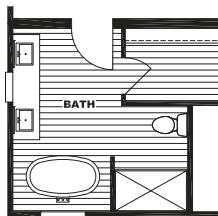

EXCLUSIVE TO CLAYTON HOMES RETAILERS

Emmeline

52FRM28764AH | 4 beds | 2 baths | 2,001 sq. ft. | 28x76

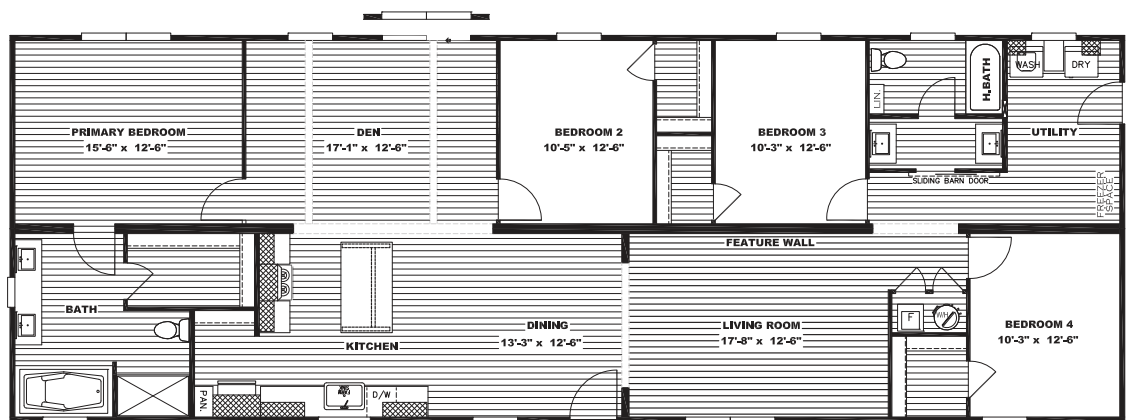

Standard Features

- White, Clay or Flint vinyl siding with OSB sheathing
- 30 Year Architectural Weatherwood shingles
- 20' dormer with SmartPanel insert and columns
- Dual porch lights at front door
- Artisan front door (Blue or White)
- Optional artisan 6 pane glass front door (blue or white)
- Full-view storm door
- Ring® HD video doorbell
- Kwikset® black interior and exterior door hardware
- Sliding glass patio door
- Tape and textured walls throughout
- 3" iron mountain pine or white trim around doors, windows, at the ceiling, and baseboards in linoleum areas
- Shaw Resilient® linoleum standard in all living rooms, primary bedrooms, and wet areas
- Custom wood shelving in closets with rod
- Shiplap feature wall (POG) with W/B for TV
- Shaw Resilient® R2X® 25 oz residential carpet is standard in spare bedrooms with built-in stain treatment
- Iron mountain pine ceiling beams
- 200 amp service
- Black ceiling fan with light in primary bedroom and living room or den
- USB recept in islands
- Large single-level island
- Iron mountain pine screen barn door to hall bath
- Screen pantry door
- DuraCraft® cabinets in three colors (we can also add four island colors) with shaker profile. PVC scratch-resistant and water-repellant
- Drawer over base door construction
- 43" overhead cabinets
- Frigidaire® appliances in stainless steel
- Package includes 26' side-by-side with water/ice, smooth top range, dishwasher, and stainless steel microwave over range
- Pfister® brushed nickel gooseneck faucet with sprayer in stainless steel farmhouse apron sink
- Two black pendant lights over the island
- All homes are constructed with eBuilt® features
- R-22/R-13/R-38 insulation values
- Overhead air ducts
- Lux Low-E windows – 60", 4 over 1 gridded wit bronze finish
- ecobee® Smart Thermostat
- Rheem® hybrid heat pump 40-gallon water heater
- SmartComfort® Carrier® furnace – electric up-flow air
- LED can lights throughout
- Drop-in tub with 36x48 window
- 60" fiberglass shower with black pivot door in primary bath
- Square porcelain sinks
- Pfister® black faucets in both baths
- Iron mountain pine or white trimmed mirrors
- 60" fiberglass tub/shower combo in hall bath
- Drop-in tub w/ 36x48 window

Available Upgrades

- | | | |
|---|--|---|
| <input type="checkbox"/> Wind Zone 2 | <input type="checkbox"/> Add Carpet in Primary Bedroom (Multi-Sections Only) | <input type="checkbox"/> Frigidaire® Washer & Dryer |
| <input type="checkbox"/> Wind Zone 3 | <input type="checkbox"/> Add Lino to Bedroom | <input type="checkbox"/> Smart Home Upgrade Package (Includes Ring Doorbell, ecobee®, Smart Thermostat, Smart Switches in Living Area, 2 Smart Plugs, Amazon Echo Show) |
| <input type="checkbox"/> 2x6 Exterior Walls | <input type="checkbox"/> Add 5 Gallons Exterior Paint | <input type="checkbox"/> Optional Freestanding Designer Tub |
| <input type="checkbox"/> 30 # Roof Load | <input type="checkbox"/> Add 2 Extra Gallons Interior Paint to Ship Loose | <input type="checkbox"/> Optional SmartPanel Exterior Siding |
| <input type="checkbox"/> 40 # Roof Load (Colorado Only) | <input type="checkbox"/> 2" Blinds Throughout | <input type="checkbox"/> Optional 36x60 Mulled Windows ipo Sliding Glass Door in Den |
| <input type="checkbox"/> Gas Range | <input type="checkbox"/> Gas Furnace w/ Floor Registers | <input type="checkbox"/> Optional Coat Locker IPO Freezer Space |
| <input type="checkbox"/> 60" Six3Tile® Shower | <input type="checkbox"/> 100 AMP Service | |
| <input type="checkbox"/> Lino Throughout | <input type="checkbox"/> AC Disconnect | |

Customer Name _____ Customer Signature _____

Phone Number _____ County _____

CSM _____

*All Options Subject to Change Without Notice

View your color options and more with our virtual Home Builder at nxtathens.com